

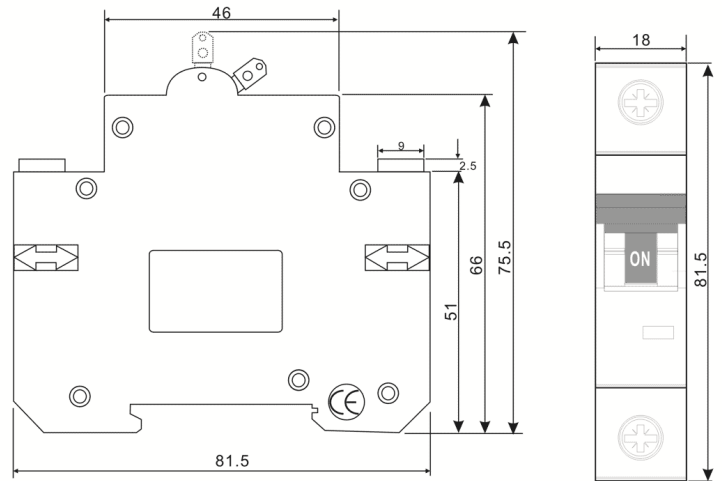

## MCB 10A C Curve 1 Pole 6kA



- 6kA Short circuit breaking capacity
- Ratings from 6A to 63A
- Available in 1, 2, 3 and 4 pole
- B or C curve overcurrent options

## G06-1C10

### TECHNICAL DATA

Operating Voltage	230 - 400V~
Rated Current	10A
Frequency	50/60Hz
ICC Rating (kA)	6
Trip Curve	C
Phase	1
Energy limiting class	3
Rated Impul. Withstand Voltage	4kV
Poles	1
Execution	DIN RAIL MOUNTING
No. of Din rails modules	1
Ingress Protection Rating	IP20

### REGISTRY

Barcode	5026992048238
Pkg. level 1 Product Qty.	12
Pkg. level 1 Dimension (HWD)	230x90x80 mm
Pkg. level 1 Volume (CD3)	1.65
Pkg. level 1 Gross weight (kg)	1.131
Pkg. level 1 carton weight (kg)	0.051

### REFERENCE STANDARDS

- ROHS Regulations 2012, Waste Electrical & Electronic Equipment Regulations 2013 The Electrical Equipment (Safety) Regulations 2016
- BS EN 60898-1:2019